

Important information

- Read all instructions carefully before using the study autoinjector.
- If you have symptoms of a heart attack,
 - **inject the investigational drug;**
 - **call 911 or get emergency medical help right away,** even if the symptoms go away; and
 - **do not inject a second dose.**
- **DO NOT remove** the cap until you are ready to inject.
- **To avoid contamination, do not ever re-cap** or store your study autoinjector **for later use** after you remove the cap.
- **Throw away** the cap immediately after injection as it may become a choking hazard for children.
- **Do not re-use** the study autoinjector.
- **Do not inject through your clothing.**
- **Do not touch** the white needle guard to avoid injuries.
- **Check** the study autoinjector often to make sure it is not damaged.

Do not use the study autoinjector if

- the expiration date has passed;
- the red safety seal is broken;
- there is any damage or leakage;
- the drug in the viewing window is not clear to light yellow in colour or has particles in it;
- it has been submerged underwater;
- it is frozen or has been frozen and thawed; or
- it has been exposed to extreme heat.

Study autoinjector storage

- Store the study autoinjector at temperatures between 59°F – 77°F (15°C – 25°C) until its expiration.
- **Do not freeze** the study autoinjector.
- **Do not expose** the study autoinjector to extreme heat. For example, do not store it in the glove box of your vehicle.
- Keep the study autoinjector out of reach of children.

Instructions for use

ID-076A301 / SOS-AMI study

Selatogrel 16 mg or placebo in 0.5 mL solution.
Single-dose autoinjector for subcutaneous use.

The study autoinjector components are shown below

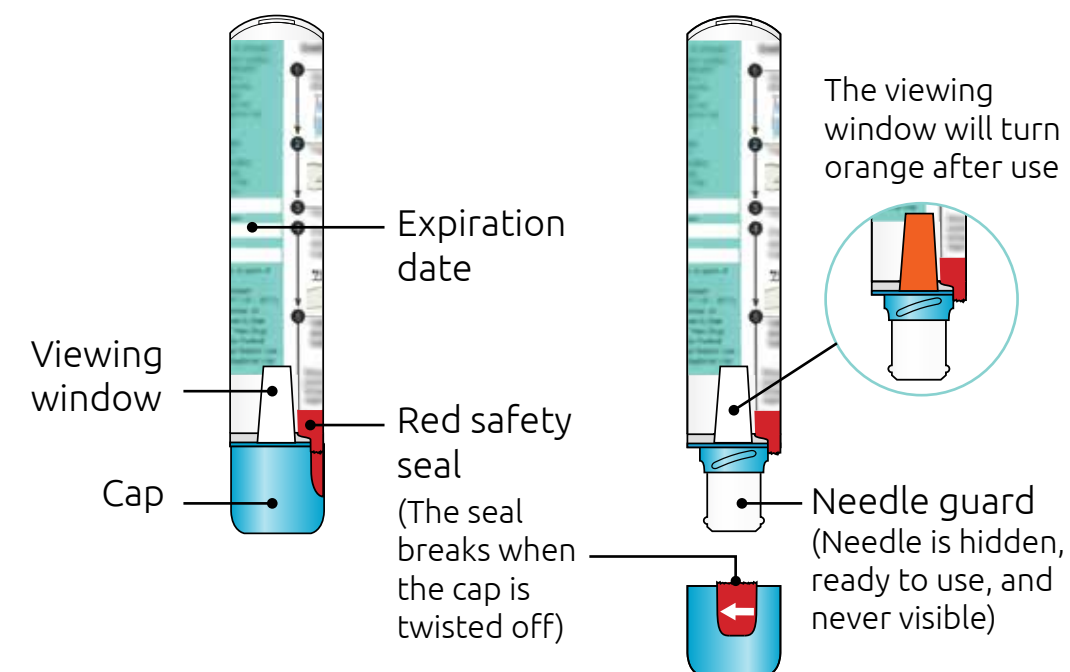

How to use the study autoinjector

Step 1: Choose an injection site

- **Stomach (abdomen) or thigh**
- **Do not** inject into skin that is tender, damaged, has bruises or scars, or into areas with visible veins.
- **Do not** inject through clothes.

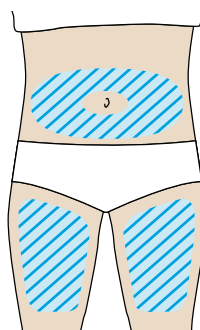

Step 2: Twist cap off

- Twist counterclockwise to remove the cap.
- **Do not** remove the cap until you are ready to inject.
- **Do not** touch the needle guard with your fingers. The needle is inside the needle guard.
- **Do not** put the cap back on the study autoinjector after you have removed it.

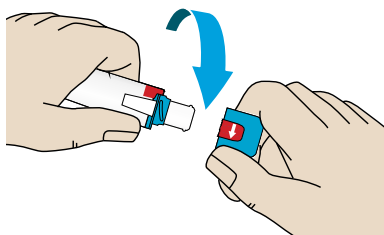

Step 3: Pinch the skin and place the study autoinjector

- Pinch skin at the injection site, creating an area about 2 inches wide.
- Place the study autoinjector at 90-degrees (perpendicular) on the pinched skin.

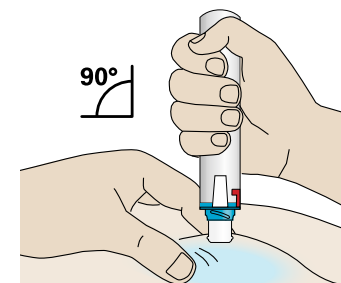

Step 4: Firmly push down and hold for 3 seconds

- Firmly push the study autoinjector down until it clicks.
- Continue to **hold for 3 seconds** while keeping skin pinched.

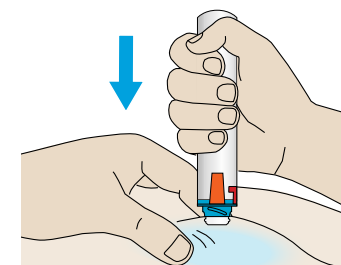

The viewing window will turn orange once the injection has been completed.

Step 5: Call 911 or get emergency medical help right away

- Tell 911 or the emergency medical responder about your symptoms and about the study autoinjector.

911

Show the used study autoinjector to the emergency medical responder

Do not throw away (dispose of) the study autoinjector